

**MRF 1.6/5.6
SERIES**

RF CO-AXIAL CONNECTORS

MODEL IEC169-13 1.6/5.6 COAXIAL CONNECTORS

Overview

The MRF1.6/5.6 series coaxial connectors comply with the IEC 169-13 1.6/5.6, and are compatible with three types of mating systems with a characteristic impedance of 75Ω . These connectors are widely used mainly for transmission and switching equipment.

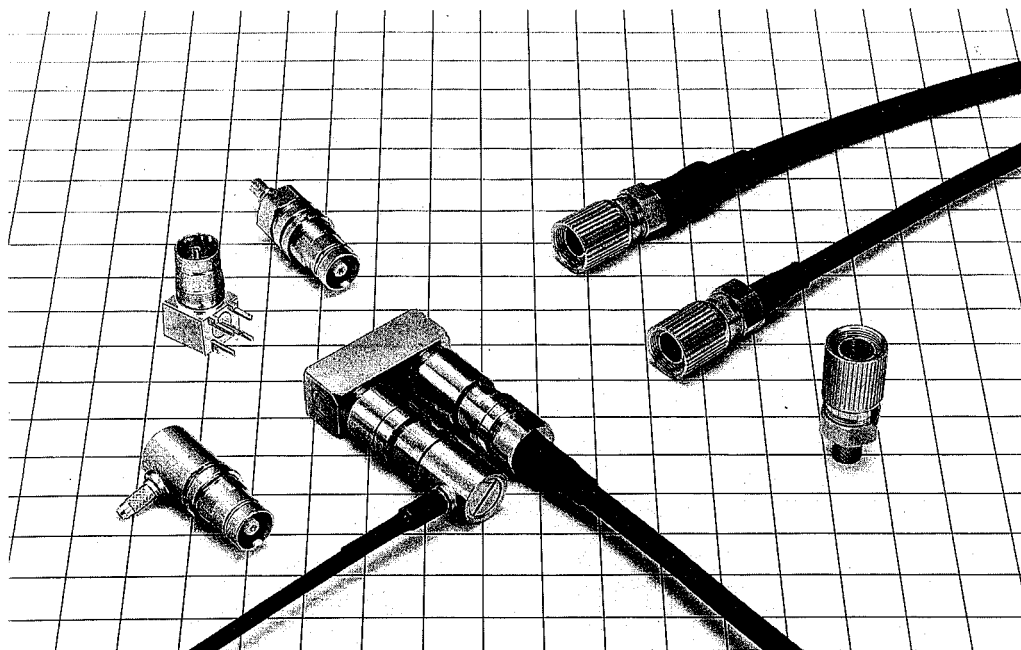

Features

- (1) Complies with IEC 169-13.
- (2) Compatible with three types of mating systems according to applications.
The jack can be used for three types of mating systems.
<(mating systems)> : A : Screw coupling B : Push-on C : Plug-in (A : Standard).
- (3) Suitable for small cables of 3C-2W or less.
- (4) Reduced in diameter to 70% of the BNC series.

Applications

Transmission and switching equipment, electronic measuring instruments, communications equipment, video equipment, and controllers.

MRF 1.6/5.6 SERIES

RF CO-AXIAL CONNECTORS

Material/Finish

| Part | Material | Finish |
|-------------------------|---------------------|---------------------------------|
| Armor (shell) | Brass | Nickel -plated Silver-plated |
| Center contact (male) | Brass | Gold-plated |
| Center contact (female) | Beryllium copper | Gold-plated |
| Outer contact (male) | Phosphor bronze | Gold-plated |
| Outer contact (female) | Brass | Gold-plated |
| Insulation | Tetrafluoride resin | — |
| Crimp sleeve | Copper | Nickel -plated |
| Heat shrinkable tube | Polyolefin | — |

Performance

| Item | Standard |
|--------------------------|--|
| Contact resistance | 4m Ω (center), 2m Ω (outer) or less at 1 ADC |
| Insulation resistance | 1,000M Ω or higher at 50 0VDC |
| Withstand voltage | 1,000 VAC for 1 min. |
| Characteristic impedance | 75 Ω |
| VSWR | 1.2 or less at DC-500MHz |

Schematic

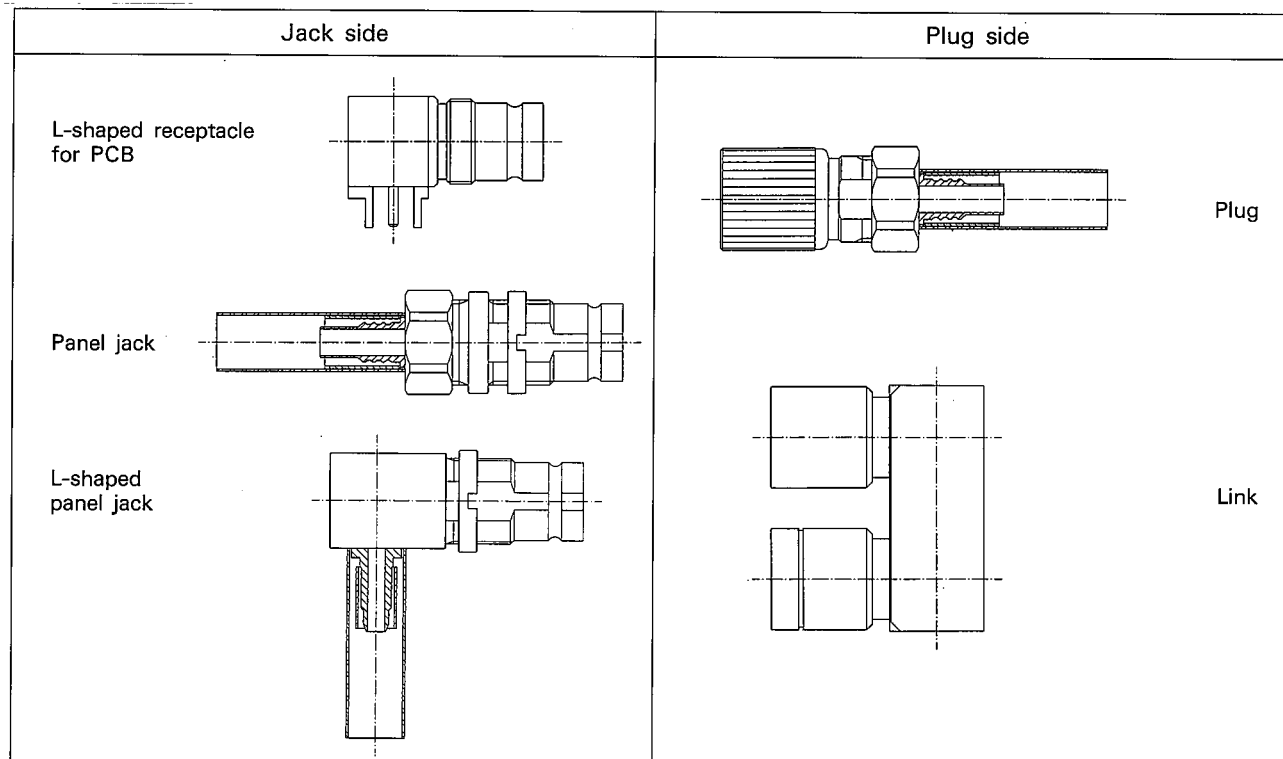

MRF 1.6/5.6 SERIES

RF CO-AXIAL CONNECTORS

Mating system identification

The Mating system is identified by the alphabetic characters preceding the letters indicating the type of a plug part number.

<Plug part number identification>

MRF1.6/5.6-※₁P-※₂

Letter indicating mating system

Letter indicating plug type

Letter indicating mating system

Series name

<Letters indicating mating system>

A or none : Screw coupling,

B : Push-on

C : Plug-in

Plug

| HRS No. | Part No. | Applicable cable | Connecting tool | Dimension "A" |
|--------------|--------------------|------------------|---------------------|---------------|
| CL313-0329-7 | MRF(1.6/5.6)-P-3C | 3C-2V, 3C-2WS | MRF(1.6/5.6)-T-1 | 26.2 |
| CL313-0393-6 | MRF1.6/5.6-AP-2.5C | 2.5C-2V | HRM-T-4(58A/U hole) | 30 |
| CL313-0397-7 | MRF1.6/5.6-AP-59U | RG-59/U | MRF(1.6/5.6)-Z-1 | 26.2 |

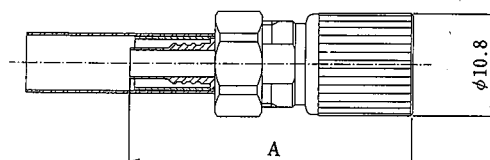

Panel jack

| HRS No. | Part No. | Applicable cable | Connecting tool | Dimension "A" |
|--------------|--------------------|------------------|----------------------|---------------|
| CL313-0394-9 | MRF1.6/5.6-PJ-2.5C | 2.5C-2V | HRM-T-4(58A/U hole) | 32 |
| CL313-0398-0 | MRF1.6/5.6-PJ-59U | RG-59U | MRF(1.6/5.6)-T-1 | 28.2 |
| CL313-0399-2 | MRF1.6/5.6-PJ-179U | RG-179/U | UM-MSS-T-1(1.5 hole) | 30.75 |

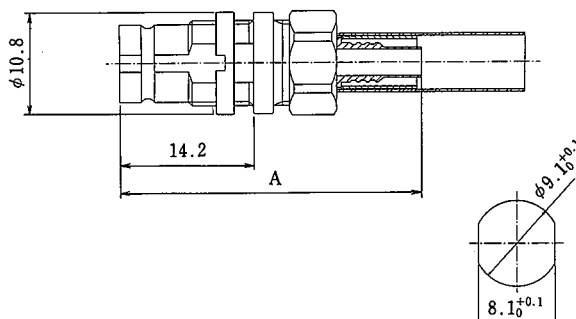
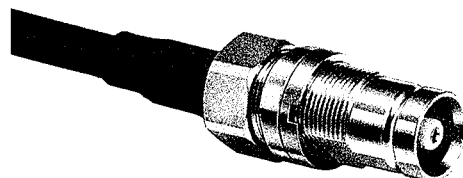

Panel cutout dimensions,
Panel thickness: 1~2.5mm

MRF1.6/5.6 SERIES

RF CO-AXIAL CONNECTORS

L-shaped panel jack

| HRS No. | Part No. | Applicable cable | Connecting tool | Dimension "A" |
|--------------|---------------------|------------------|----------------------|---------------|
| CL313-0395-1 | MRF1.6/5.6-LPJ-179U | RG-179/U | UM•MSS-T-1(1.5 hole) | 18.75 |

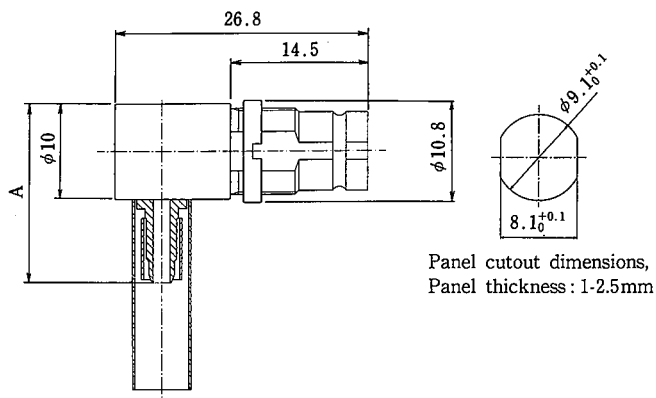
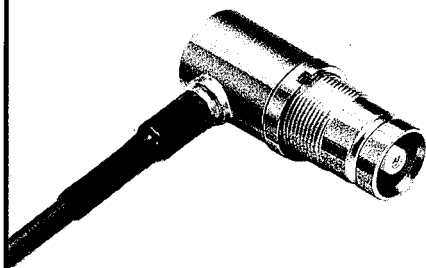

L-shaped receptacle for PCB

| HRS No. | Part No. | Dimension "A" |
|--------------|--------------------|---------------|
| CL313-0330-6 | MRF(1.6/5.6)-LR-PC | 4.1 |
| CL313-0390-8 | MRF1.6/5.6-LR-PC-1 | 3.1 |

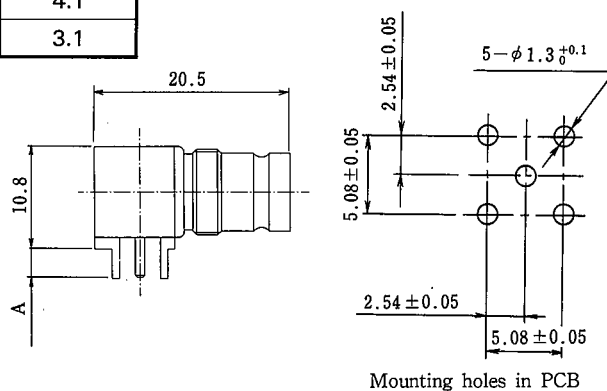
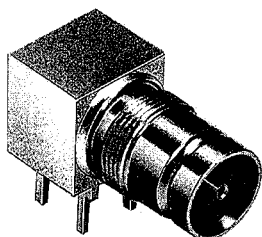

U link

| HRS No. | Part No. |
|--------------|------------------|
| CL313-0396-4 | MRF1.6/5.6-BCUPA |

